

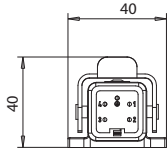

Composed by: cover, receptacle and strain relief.
Bestehend: Gehäuse, Zugentlastung und Buchse/Stecker.

Diagram of connectors assemblies composed by: cover, box and receptacle.
Schema des zusammengesetzten Verbindungssets bestehend aus: Gehäuse, Steckverbinder und Buchse/Stecker.

| N. plug Menge | Q.ty poles Menge polig | code Code |
|------------------|---------------------------------|--------------|
| n° 1 | 4 Male poles 4 Arretierstift | E16833 |



| N. plug Menge | Q.ty poles Menge polig | code Code |
|------------------|-------------------------------------|--------------|
| n° 1 | 10 female poles 10 Arretierhülse | E15761 |
| n° 1 | 10 Male poles 10 Arretierstift | E05128 |

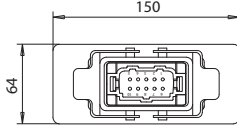

| N. plug Menge | Q.ty poles Menge polig | code Code |
|------------------|-------------------------------------|--------------|
| n° 1 | 16 female poles 16 Arretierhülse | E09509 |
| n° 1 | 16 Male poles 16 Arretierstift | E05129 |

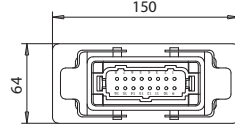

| N. plug Menge | Q.ty poles Menge polig | code Code |
|------------------|-------------------------------------|--------------|
| n° 1 | 24 female poles 24 Arretierhülse | E09510 |
| n° 1 | 24 Male poles 24 Arretierstift | E05131 |

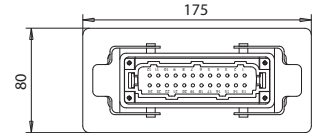

| N. plug Menge | Q.ty poles Menge polig | code Code |
|------------------|-------------------------------------|--------------|
| n° 1 | 16 female poles 16 Arretierhülse | E08102 |
| n° 1 | 16 Male poles 16 Arretierstift | |

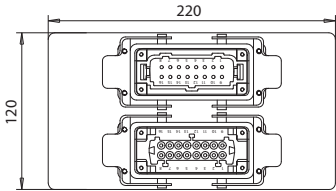

| N. plug Menge | Q.ty poles Menge polig | code Code |
|------------------|--|--------------|
| n° 1 | 16 female poles 16 Arretierhülse + 16 Male poles 16 Arretierstift | E05134 |

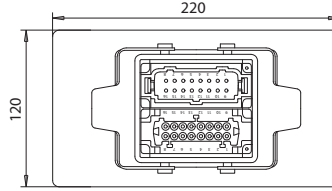

| N. plug Menge | Q.ty poles Menge polig | code Code |
|------------------|-------------------------------------|--------------|
| n° 1 | 24 female poles 24 Arretierhülse | E05137 |
| n° 1 | 24 Male poles 24 Arretierstift | |

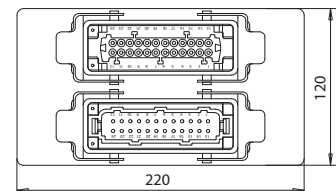

| N. plug Menge | Q.ty poles / Menge polig | | code Code |
|------------------|--------------------------|--------------------|--------------|
| n° 1 | 24 female poles | 24 Arretierhülse + | E05140 |
| n° 1 | 24 Male poles | 24 Arretierstift | |
| n° 1 | 16 Male poles | 16 Arretierstift | |

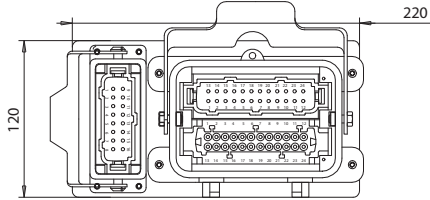

| N. plug Menge | Q.ty poles / Menge polig | | code Code |
|------------------|--------------------------|------------------|--------------|
| n° 1 | 32 female poles | 32 Arretierhülse | E05143 |
| n° 1 | 32 Male poles | 32 Arretierstift | |
| n° 1 | 16 Male poles | 16 Arretierstift | |

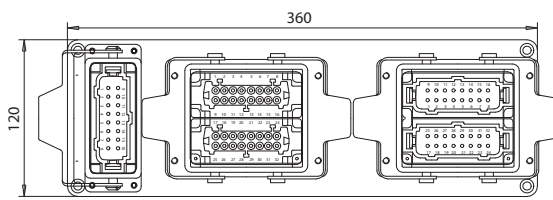

| N. plug Menge | Q.ty poles Menge polig | code Code |
|------------------|-------------------------------------|--------------|
| n° 1 | 32 Male poles 32 Arretierstift | E05145 |
| n° 1 | 32 female poles 32 Arretierhülse | |
| n° 1 | 24 Male poles 24 Arretierstift | |

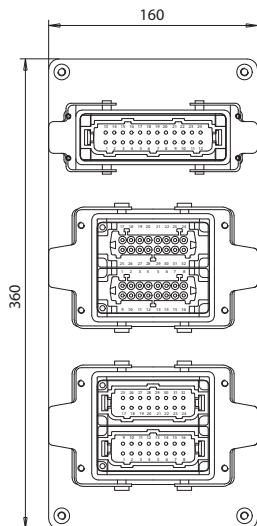

| N. plug Menge | Q.ty poles Menge polig | code Code |
|------------------|-------------------------------------|--------------|
| n° 1 | 48 Male poles 48 Arretierstift | E05148 |
| n° 1 | 48 female poles 48 Arretierhülse | |
| n° 1 | 24 Male poles 24 Arretierstift | |

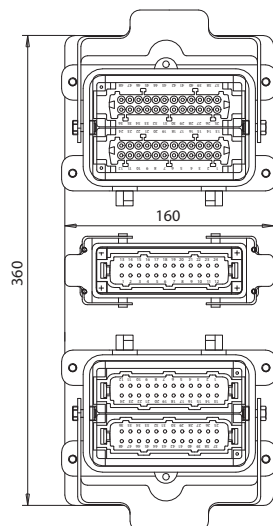

| N. plug Menge | Q.ty poles Menge polig | code Code |
|------------------|-------------------------------------|--------------|
| n° 1 | 48 Male poles 48 Arretierstift | E05150 |
| n° 1 | 48 female poles 48 Arretierhülse | |
| n° 1 | 24 Male poles 24 Arretierstift | |
| n° 1 | 24 female poles 24 Arretierhülse | |

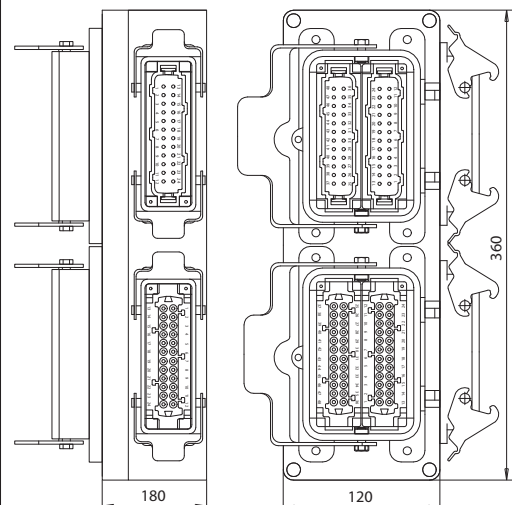



| Qty / Menge | Code / Code | E05151 |
|-------------|-------------------------------------|--------|
| n°2 | 32 Female poles 32 Arretierhülse | |
| n°2 | 32 Male poles 32 Arretierstift | |
| n°1 | 24 Female poles 24 Arretierhülse | |
| n°1 | 24 Male poles 24 Arretierstift | |

| Qty / Menge | Code / Code | E05152 |
|-------------|-------------------------------------|--------|
| n°2 | 48 female poles 48 Arretierhülse | |
| n°2 | 48 male poles 48 Arretierstift | |

| Qty / Menge | Code / Code | E05155 |
|-------------|-------------------------------------|--------|
| n°2 | 48 Male poles 48 Arretierstift | |
| n°2 | 48 Female poles 48 Arretierhülse | |
| n°1 | 24 Male poles 24 Arretierstift | |
| n°1 | 24 Female poles 24 Arretierhülse | |



ELECTRICAL CONNECTOR
4 poles - 240V - 10A

STECKVERBINDUNGEN
4 polig - 240V - 10A

Cables
min. 6
max. 12
Kabeldurchmesser
min. 6
max. 12

HOOD / GEHÄUSE

Code / Code E16188

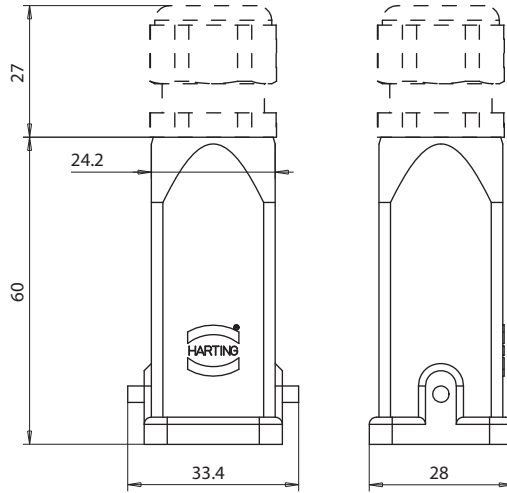

RECEPTACLE / BUCHSE

Code / Code E11160

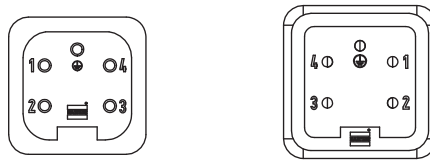

PLUG / STECKER

Code / Code E16186

BASE / KUPPLUNG FÜR STECKERGEHÄUSE

BASE / KUPPLUNG FÜR STECKERGEHÄUSE

Code / Code E11161

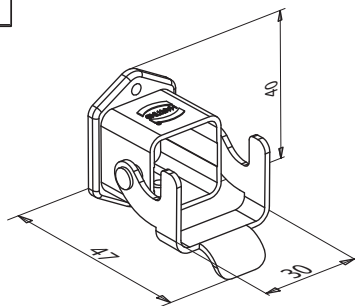

PLUG / STECKER

Code / Code E16834

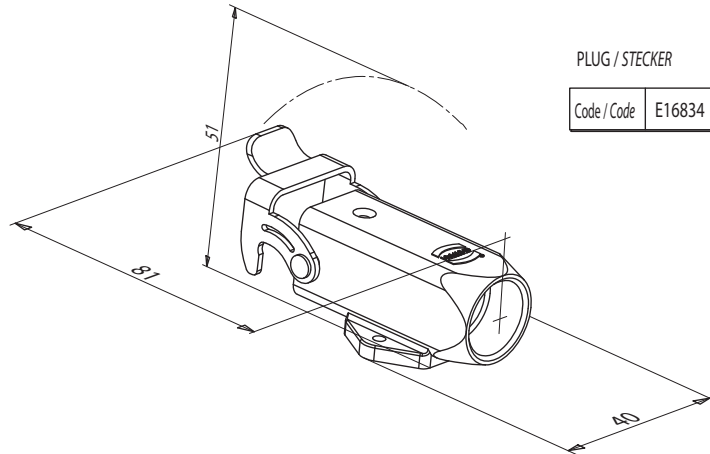

Layout to attach base to mold
Montageskizze für Gehäuse auf dem Werkzeug

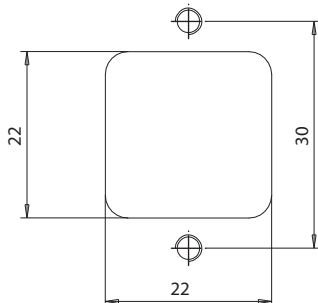

To mount base use n 2 screws M3x10 UNI 5931
Zur Befestigung des Gehäuses werden 2 Schrauben M3x10 UNI 5931 benötigt



STRAIN RELIEF FITTING / KUPPLUNG FÜR ZUGENTLASTUNG

Code / Code E16187

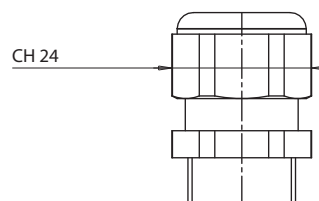

Cables
min. 6
max. 12
Kabeldurchmesser
min. 6
max. 12

CONNECTORS / STECKVERBINDUNGEN



ELECTRICAL CONNECTOR
6 poles - 240V - 35A

STECKVERBINDUNGEN
6 polig - 240V - 35A

Cables
min. 19
max. 29
Kabeldurchmesser
min. 19
max. 29

Code / Code E04238

HOOD / GEHÄUSE

Code / Code E04239

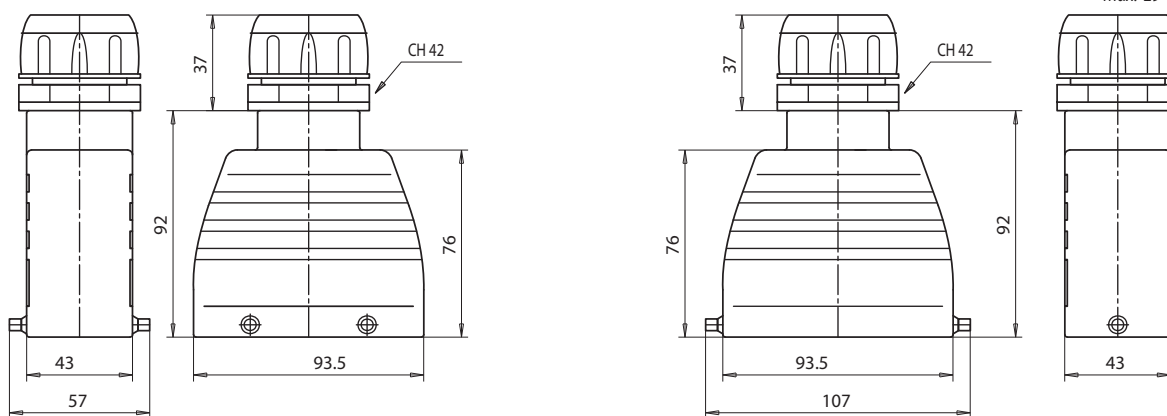

RECEPTACLE / BUCHSE

Code / Code E04213

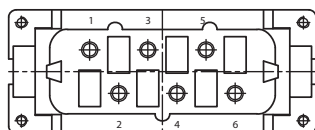

Mounting screw
Befestigungsschrauben

PLUG / STECKER

Code / Code E04212

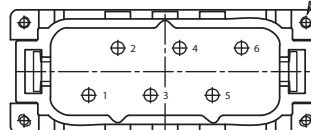

BASE / KUPPLUNG FÜR STECKERGEHÄUSE

Code / Code E04237

BASE / KUPPLUNG FÜR STECKERGEHÄUSE

Code / Code E04236

BASE / KUPPLUNG FÜR STECKERGEHÄUSE

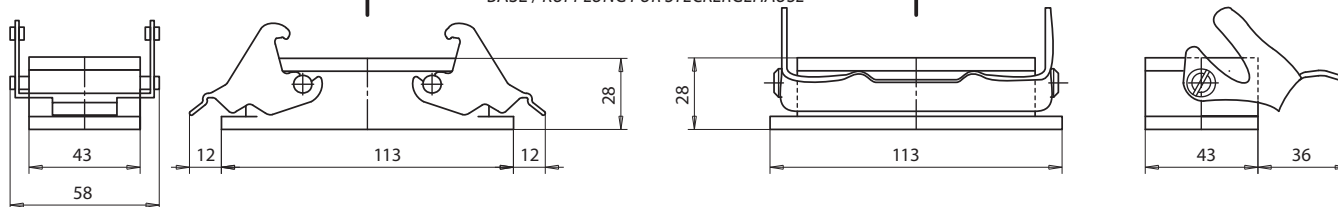

CODING PIN FEMALE
ARRETIERHÜLSE

Code / Code E04254



Where several plugs are mounted adjacent to one another, substitute these pins to avoid errors.

Um fehlerhafte Montagen zu vermeiden sind ein Paar oder mehrere Arretierhülsen und -stifte zu montieren.



CODING PIN MALE
ARRETIERSTIFT

Code / Code E04253

Layout to attach base to mold
Montageskizze für Gehäuse auf dem Werkzeug

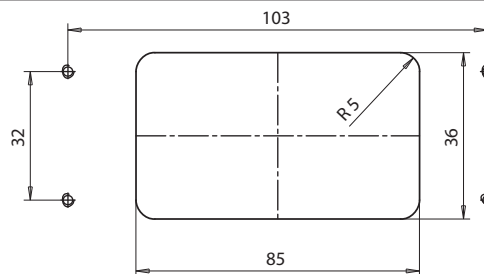

To mount base use n4 screws M4x12 UNI 5931

Zur Befestigung des Gehäuses werden 4 Schrauben M4x12 UNI 5931 benötigt

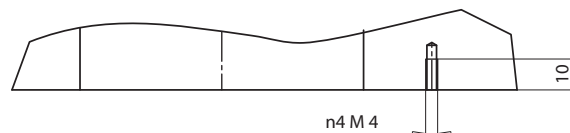

STRAIN RELIEF FITTING / KUPPLUNG FÜR ZUGENTLASTUNG

| Code / Code | Cables / Kabeldurchmesser | | PG | CH |
|-------------|---------------------------|-----|------|----|
| | min | max | | |
| E11119 | 13 | 18 | PG21 | 36 |
| E11120 | 18 | 25 | PG29 | 42 |

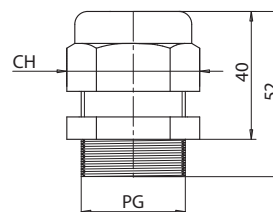



ELECTRICAL CONNECTOR
10 poles - 240V - 16A

STECKVERBINDUNGEN
10 polig - 240V - 16A

Cables
min. 19
max. 29
Kabeldurchmesser
min. 19
max. 29

Code / Code E04232

HOOD / GEHÄUSE

Code / Code E04233

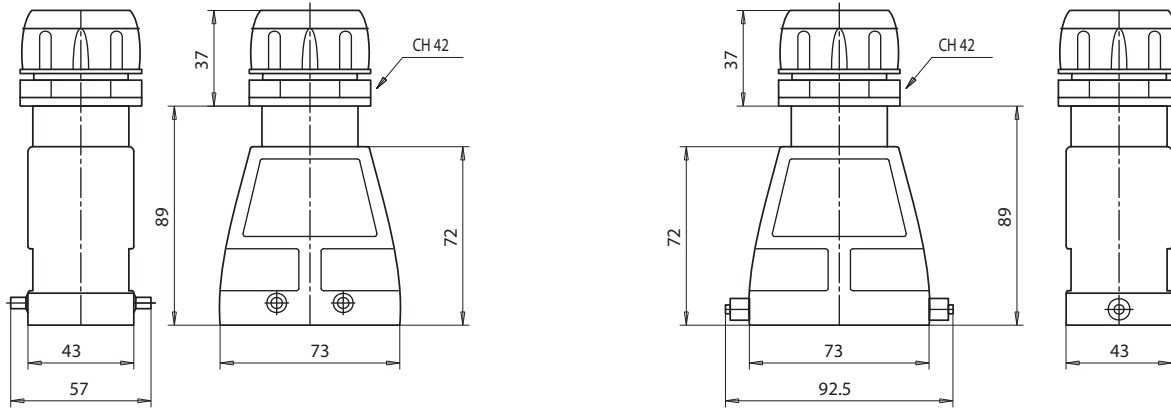

RECEPTACLE / BUCHSE

Code / Code E04215

BASE / KUPPLUNG FÜR STECKERGEHÄUSE

Code / Code E04230

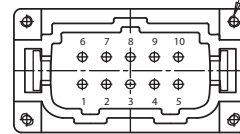
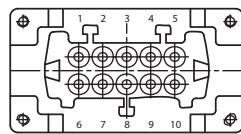

PLUG / STECKER

Code / Code E04214

BASE / KUPPLUNG FÜR STECKERGEHÄUSE

Code / Code E04231

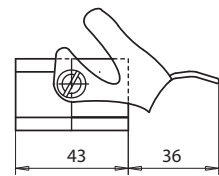
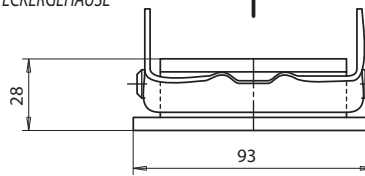
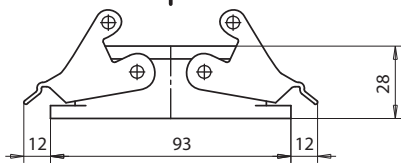
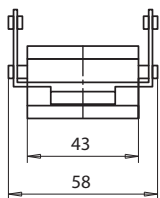

CODING PIN FEMALE
ARRETIERHÜLSE

code / Code E04254



Where several plugs are mounted adjacent to one another, substitute these pins to avoid errors.

Um fehlerhafte Montagen zu vermeiden sind ein Paar oder mehrere Arretierhülsen und -stifte zu montieren.



CODING PIN MALE
ARRETIERHÜLSE

code / Code E04253

Layout to attach base to mold
Montageskizze für Gehäuse auf dem Werkzeug

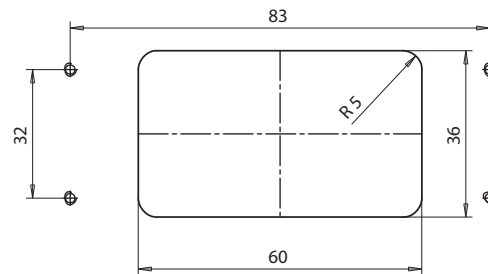

To mount base use n4 screws M4x12 UNI 5931

Zur Befestigung des Gehäuses werden 4 Schrauben M4x12 UNI 5931 benötigt

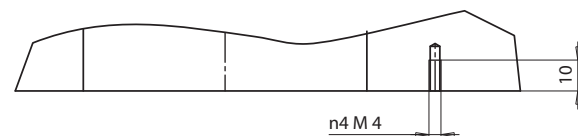

STRAIN RELIEF FITTING / KUPPLUNG FÜR ZUGENTLASTUNG

| Code / Code | Cables / Kabeldurchmesser | | PG | CH |
|-------------|---------------------------|-----|------|----|
| | min | max | | |
| E11119 | 13 | 18 | PG21 | 36 |
| E11120 | 18 | 25 | PG29 | 42 |

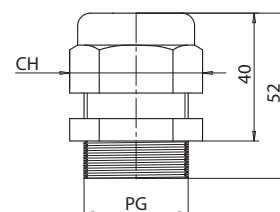



ELECTRICAL CONNECTOR
12 poles - 240V - 35A

STECKVERBINDUNGEN
12 polig - 240V - 35A

Cables
min. 19
max. 29
Kabeldurchmesser
min. 19
max. 29

HOOD / GEHÄUSE

Code / Code E04245

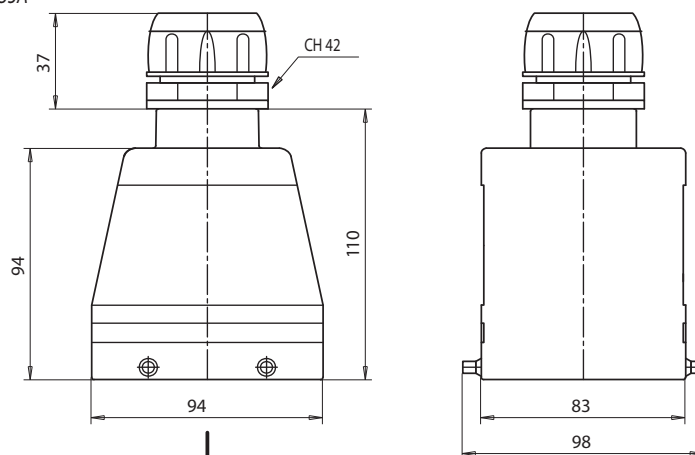

Mounting screw
Befestigungsschrauben

RECEPTACLE / BUCHSE

Code / Code E04213

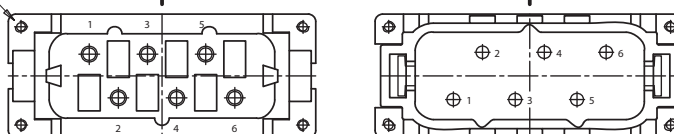

PLUG / STECKER

Code / Code E04212

RECEPTACLE / BUCHSE

Code / Code E04217

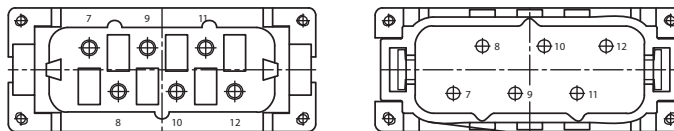

PLUG / STECKER

Code / Code E04216

BASE / KUPPLUNG FÜR STECKERGEHÄUSE

Code / Code E04244

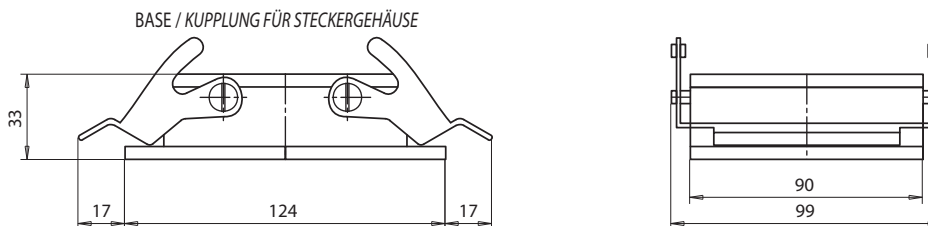

CODING PIN FEMALE
ARRETIERHÜLSE

Code / Code E04254



Where several plugs are mounted adjacent to one another, substitute these pins to avoid errors.

Um fehlerhafte Montagen zu vermeiden sind ein Paar oder mehrere Arretierhülsen und-stifte zu montieren.



CODING PIN MALE
ARRETIERHÜLSE

Code / Code E04253

Layout to attach base to mold
Montageskizze für Gehäuse auf dem Werkzeug

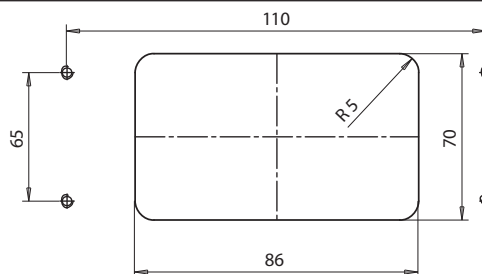

To mount base use n 4 screws M5x12 UNI 5931
Zur Befestigung des Gehäuses werden 4 Schrauben M5x12 UNI 5931 benötigt

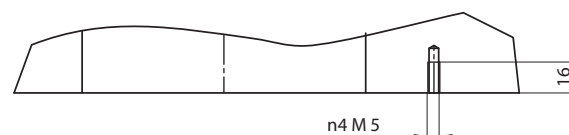

STRAIN RELIEF FITTING / KUPPLUNG FÜR ZUGENTLASTUNG

| Code / Code | Cables / Kabeldurchmesser | | PG | CH |
|-------------|---------------------------|-----|------|----|
| | min | max | | |
| E11119 | 13 | 18 | PG21 | 36 |
| E11120 | 18 | 25 | PG29 | 42 |

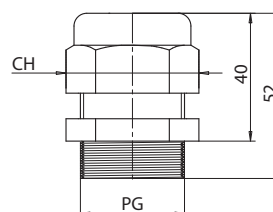

CONNECTORS / STECKVERBINDUNGEN



ELECTRICAL CONNECTOR
16 poles - 240V - 16A

STECKVERBINDUNGEN
16 polig - 240V - 16A

Cables
min. 19
max. 29
Kabeldurchmesser
min. 19
max. 29

Code / Code E04238

HOOD / GEHÄUSE

Code / Code E04239

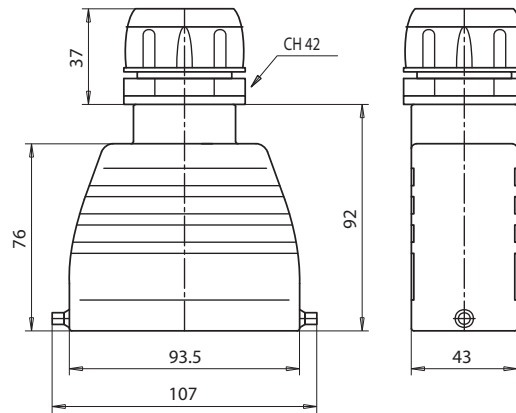
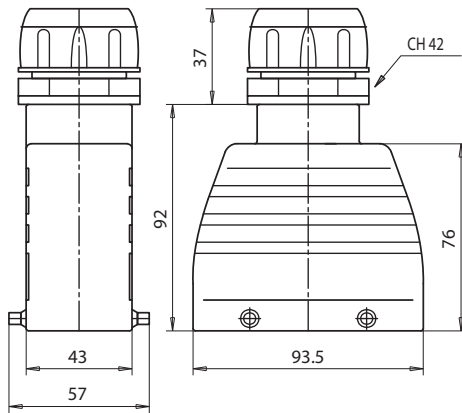

RECEPTACLE / BUCHSE

Code / Code E04219

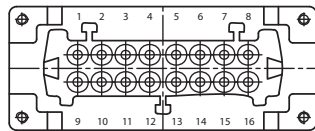

BASE / KUPPLUNG FÜR STECKERGEHÄUSE

Code / Code E04236

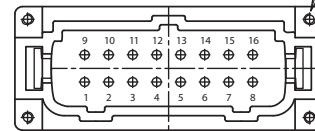

BASE / KUPPLUNG FÜR STECKERGEHÄUSE

Code / Code E04237

PLUG / STECKER

Code / Code E04218

Mounting screw
Befestigungsschrauben

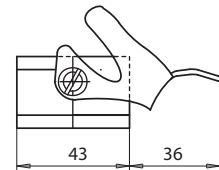
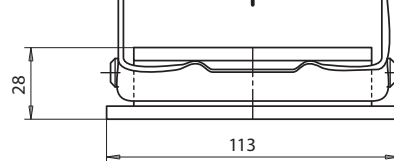
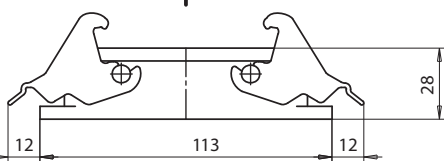
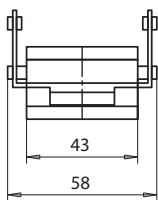

CODING PIN FEMALE
ARRETIERHÜLSE

Code / Code E04254



Where several plugs are mounted adjacent to one another, substitute these pins to avoid errors.

Um fehlerhafte Montagen zu vermeiden sind ein Paar oder mehrere Arretierhülsen und-stifte zu montieren.



CODING PIN MALE
ARRETIERHÜLSE

Code / Code E04253

Layout to attach base to mold
Montageskizze für Gehäuse auf dem Werkzeug

To mount base use n 4 screws M4x12 UNI 5931
Zur Befestigung des Gehäuses werden 4 Schrauben M4x12 UNI 5931 benötigt

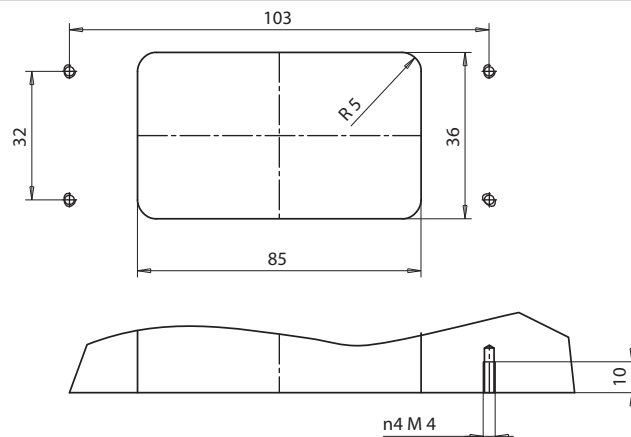

STRAIN RELIEF FITTING / KUPPLUNG FÜR ZUGENTLASTUNG

| Code / Code | Cables / Kabeldurchmesser | | PG | CH |
|-------------|---------------------------|-----|------|----|
| | min | max | | |
| E11119 | 13 | 18 | PG21 | 36 |
| E11120 | 18 | 25 | PG29 | 42 |

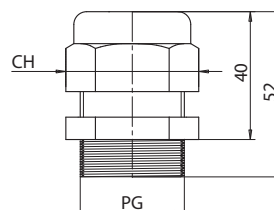



ELECTRICAL CONNECTOR
24 poles - 240V - 16A

STECKVERBINDUNGEN
24 polig - 240V - 16A

Cables
min. 19
max. 29
Kabeldurchmesser
min. 19
max. 29

Code / Code E04242

HOOD / GEHÄUSE

Code / Code E04243

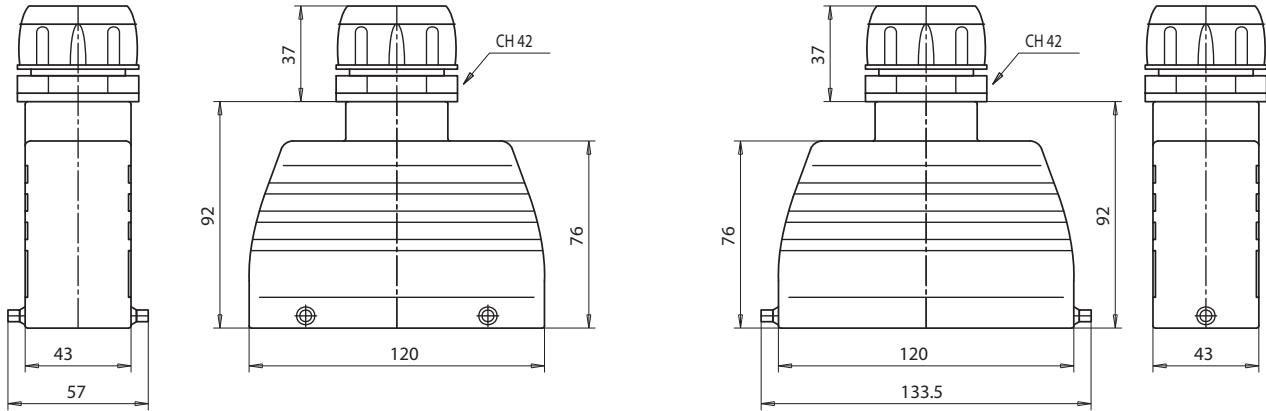

RECEPTACLE / BUCHSE

Code / Code E04221

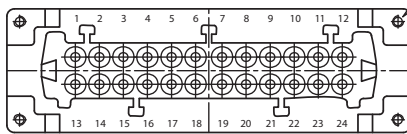

Mounting screw
Befestigungsschrauben

PLUG / STECKER

Code / Code E04220

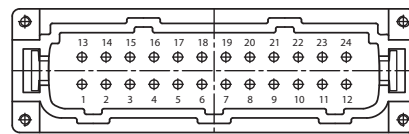

BASE / KUPPLUNG FÜR STECKERGEHÄUSE

Code / Code E04240

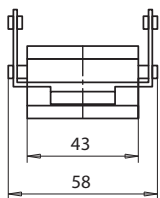

BASE / KUPPLUNG FÜR STECKERGEHÄUSE

BASE / KUPPLUNG FÜR STECKERGEHÄUSE

Code / Code E04241

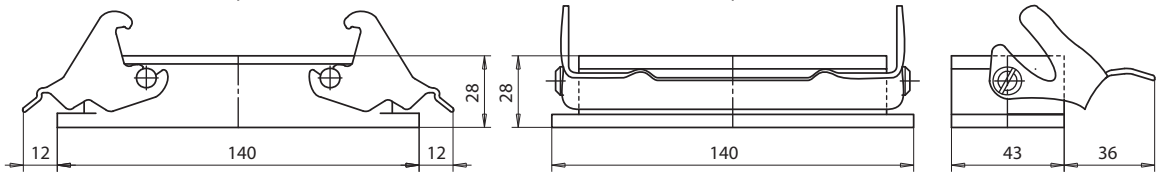

CODING PIN FEMALE
ARRETIERHÜLSE

Code / Code E04254



Where several plugs are mounted adjacent to one another, substitute these pins to avoid errors.

Um fehlerhafte Montagen zu vermeiden sind ein Paar oder mehrere Arretierhülsen und -stifte zu montieren.



CODING PIN MALE
ARRETIERHÜLSE

Code / Code E04253

Layout to attach base to mold
Montageskizze für Gehäuse auf dem Werkzeug

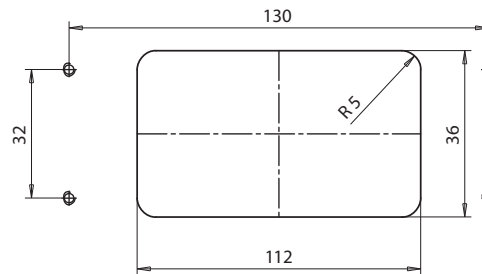

To mount base use n 4 screws M4x12 UNI 5931

Zur Befestigung des Gehäuses werden 4 Schrauben M4x12 UNI 5931 benötigt

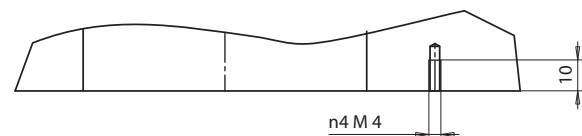

STRAIN RELIEF FITTING / KUPPLUNG FÜR ZUGENTLASTUNG

| Code / Code | Cables / Kabeldurchmesser | | PG | CH |
|-------------|---------------------------|-----|------|----|
| | min | max | | |
| E11119 | 13 | 18 | PG21 | 36 |
| E11120 | 18 | 25 | PG29 | 42 |

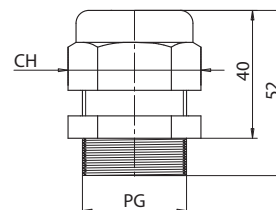



ELECTRICAL CONNECTOR
32 poles - 240V - 16A

STECKVERBINDUNGEN
32 poli - 240V - 16A

Cables
min. 19
max. 29

Kabeldurchmesser
min. 19
max. 29

HOOD / GEHÄUSE

Code / Code E04245

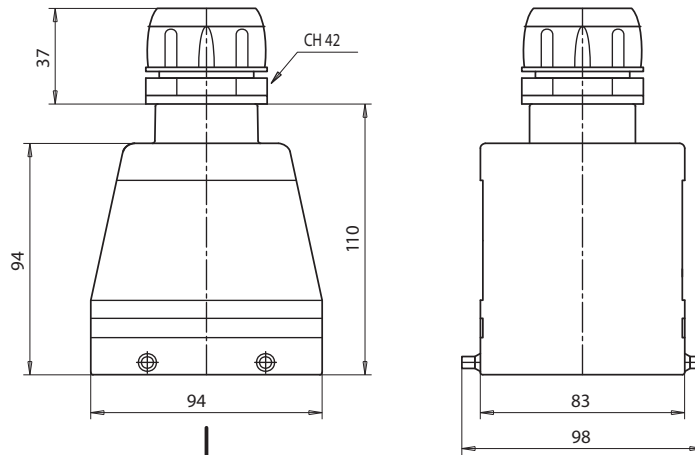

Mounting screw
Befestigungsschrauben

RECEPTACLE / BUCHSE

Code / Code E04219

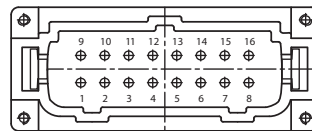
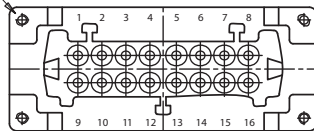

PLUG / STECKER

Code / Code E04218

RECEPTACLE / BUCHSE

Code / Code E05142

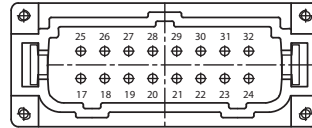
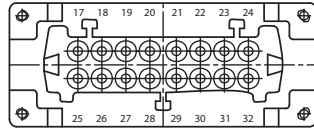

PLUG / STECKER

Code / Code E05141

BASE / KUPPLUNG FÜR STECKERGEHÄUSE

BASE / KUPPLUNG FÜR STECKERGEHÄUSE

Code / Code E04244

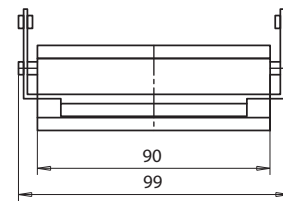
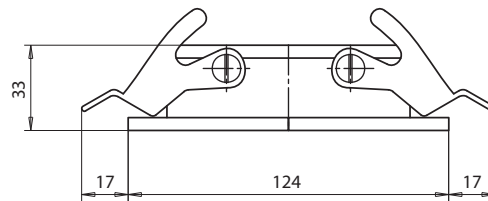

CODING PIN FEMALE
ARRETIERHÜLSE

Code / Code E04254



Where several plugs are mounted adjacent to one another, substitute these pins to avoid errors.

Um fehlerhafte Montagen zu vermeiden sind ein Paar oder mehrere Arretierhülsen und-stifte zu montieren.



CODING PIN MALE
ARRETIERHÜLSE

Code / Code E04253

Layout to attach base to mold
Montageskizze für Gehäuse auf dem Werkzeug

To mount base use n 4 screws M5x12 UNI 5931
Zur Befestigung des Gehäuses werden 4 Schrauben M5x12 UNI 5931 benötigt

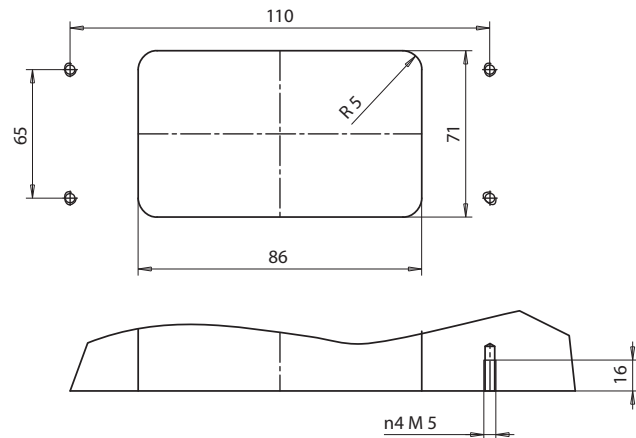

STRAIN RELIEF FITTING / KUPPLUNG FÜR ZUGENTLASTUNG

| Code / Code | Cables / Kabeldurchmesser | | PG | CH |
|-------------|---------------------------|-----|------|----|
| | min | max | | |
| E11119 | 13 | 18 | PG21 | 36 |
| E11120 | 18 | 25 | PG29 | 42 |

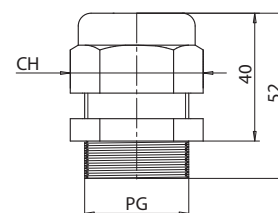



ELECTRICAL CONNECTOR

48 poles - 240V - 16A

STECKVERBINDUNGEN

48 polig - 240V - 16A

Code / Code E04247

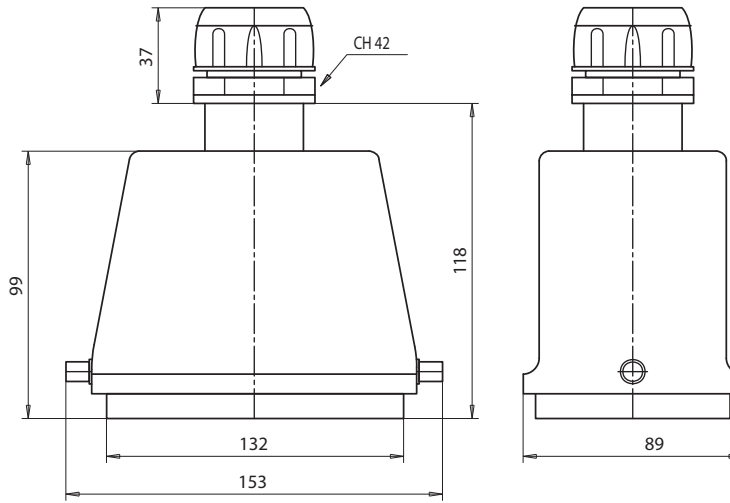

Cables
min. 19
max. 29

Kabeldurchmesser
min. 19
max. 29

Mounting screw
Befestigungsschrauben

RECEPTACLE / BUCHSE

Code / Code E04221

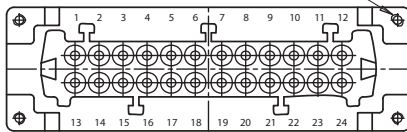

PLUG / STECKER

Code / Code E04220

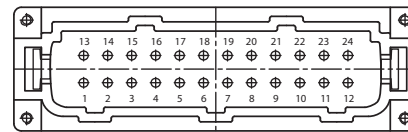

RECEPTACLE / BUCHSE

Code / Code E05147

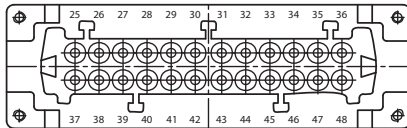

PLUG / STECKER

Code / Code E05146

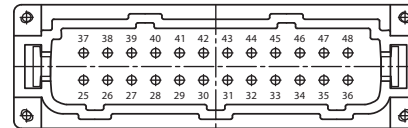

BASE / KUPPLUNG FÜR STECKERGEHÄUSE

BASE / KUPPLUNG FÜR STECKERGEHÄUSE

Code / Code E04246

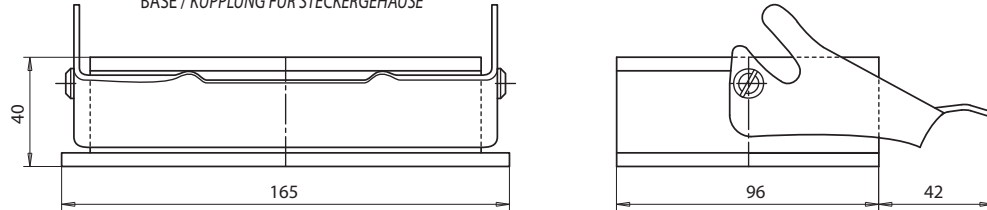

CODING PIN FEMALE ARRETIERHÜLSE

Code / Code E04254



Where several plugs are mounted adjacent to one another, substitute these pins to avoid errors.

Um fehlerhafte Montagen zu vermeiden sind ein Paar oder mehrere Arretierhülsen und -stifte zu montieren.

CODING PIN MALE ARRETIERHÜLSE

Code / Code E04253



Layout to attach base to mold

Montageskizze für Gehäuse auf dem Werkzeug

To mount base use n 4 screws M6x12 UNI 5931

Zur Befestigung des Gehäuses werden 4 Schrauben M6x12 UNI 5931 benötigt

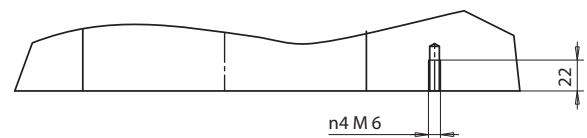
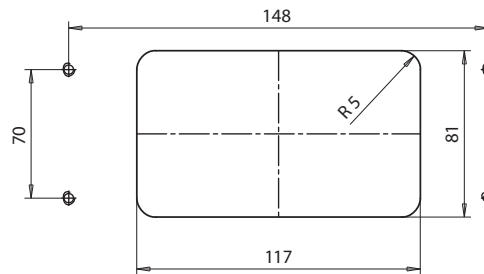

STRAIN RELIEF FITTING / KUPPLUNG FÜR ZUGENTLASTUNG

| Code / Code | Cables / Kabeldurchmesser | | PG | CH |
|-------------|---------------------------|-----|------|----|
| | min | max | | |
| E11119 | 13 | 18 | PG21 | 36 |
| E11120 | 18 | 25 | PG29 | 42 |

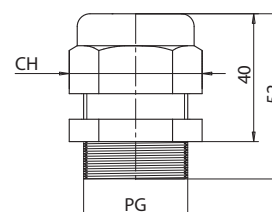



TERMINAL MOUNTING BOX / ANSCHLUSSKASTEN

Material / Material Aluminium / Aluminium

Screw hole M4/M6 to mount cover
Schraubenbefestigung M4/M6

Screw hole M4/M6 to mount terminal box
Schraubenbefestigung für Anschlußbox M4/M6

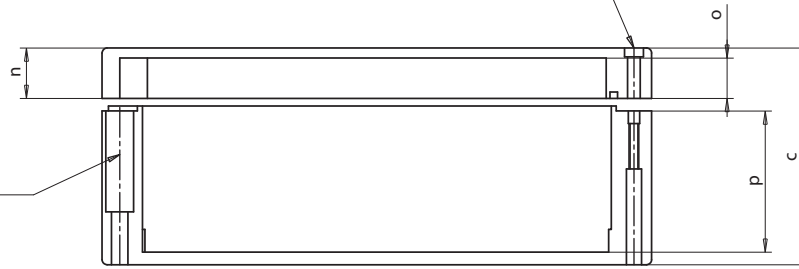

Type / Typ A

Type / Typ B

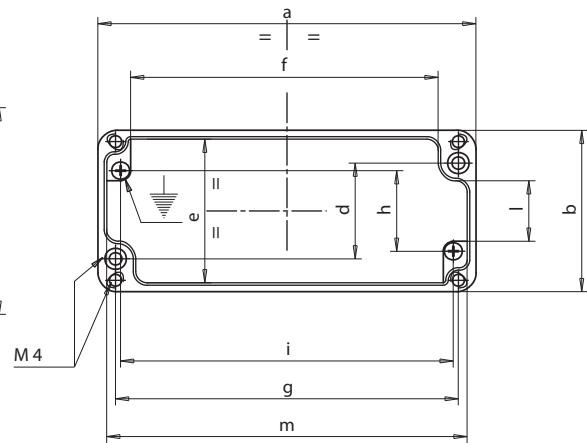
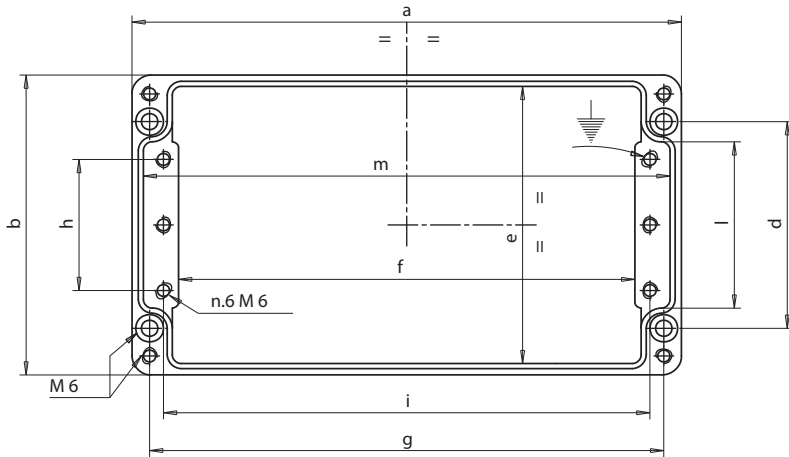

| Code | Type / Typ | a | b | c | d | e | f | g | h | i | l | m | n | o | p |
|--------|------------|-----|-----|-----|-----|-----|-----|-----|-----|-----|-----|-----|----|------|------|
| E04384 | A | 360 | 120 | 80 | 82 | 111 | 328 | 344 | 52 | 333 | 66 | 351 | 20 | 16.5 | 56.5 |
| E04385 | | 220 | | | | | 188 | 204 | | 193 | | 211 | | | |
| E04386 | | 160 | 160 | 90 | 110 | 151 | 120 | 140 | 76 | 130 | 90 | 151 | | | |
| E05144 | | 360 | | | | | 320 | 340 | 330 | 351 | | | | | |
| E05153 | | 330 | 230 | 180 | 181 | 221 | 290 | 310 | 144 | 300 | 160 | 318 | | | |
| E04387 | B | 250 | 80 | 52 | 52 | 72 | 224 | 238 | 48 | 230 | 40 | 242 | 12 | 8.5 | 36.5 |
| E04388 | | 150 | 64 | 34 | 36 | 56 | 126 | 138 | 32 | 132 | 24 | 142 | 9 | 5.5 | 21.5 |
| E05127 | | 175 | 80 | 57 | 52 | 72 | 147 | 163 | 30 | 156 | 50 | 167 | 15 | 11.5 | 38.5 |

APPLICATION EXAMPLES OF TERMINAL MOUNTING BOX / BEISPIEL FÜR ANSCHLUSSKASTEN

